

FULL LENGTH CABINETS - 2 DOORS

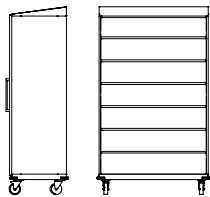

Cleanroom Full Length Storage Cabinets with 2 swing doors. All shelves are removable. Available with either leveler legs or cleanroom casters. Sloping roof is standard. Fabrication material stainless steel 304 with electropolished finish.
In stock for immediate shipping.



- Why do we recommend shipping cabinets flat packed?**
- Reduces Shipping Costs
 - Reduces likelihood of damage occurring during transport & storage
 - Interchangeable parts – allows for future alterations if required

Shipped flat packed

Product	LxWxH (mm)	LxWxH (")	Cat. No.
Full length Cabinet 2 doors 6 shelves on leveller legs	1200x600x2100	48x24x83	JF1260
Full length Cabinet 2 doors 6 shelves on casters	1200x600x2100	48x24x83	JF1260C

To ship assembled add – AS after catalog #

FULL LENGTH CABINETS - 4 DOORS

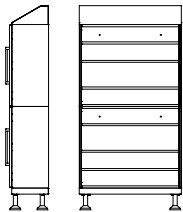

Shipped flat packed

Product	LxWxH (mm)	LxWxH (")	Cat. No.
Full length Cabinet 4 doors 6 shelves	1000x380x2000	40x15x79	Q1001
Full length Cabinet 4 doors 6 shelves	1200x450x2000	48x18x79	Q1002

To ship assembled add – AS after catalog #

FULL LENGTH CABINET - 2 DOORS



Cleanroom Full Length storage cabinets with 2 swing doors. All shelves are removable. Available with either leveller legs or on casters. Sloping roof is standard. Fabrication material stainless steel 304 with electropolished finish.

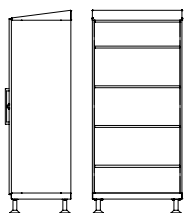

Why do we recommend shipping cabinets flat packed?

- Reduces Shipping Costs
- Reduces likelihood of damage occurring during transport & storage
- Interchangeable parts — allows for future alterations if required

Shipped flat packed

Product	LxWxH (mm)	LxWxH (")	Cat. No.
Full length Cabinet 2 doors 4 shelves on leveller legs	900x600x2100	36x24x83	JF0960
Full length Cabinet 2 doors 4 shelves on casters	900x600x2100	36x24x83	JF0960C

To ship assembled add — AS after catalog #

CLEANERS CABINET - 2 DOORS



Designed for storing mops and cleaning materials. Fabrication material stainless steel 304 with electropolished finish.

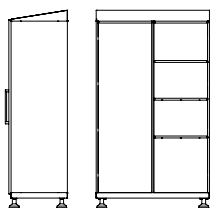

Shipped flat packed

Product	LxWxH (mm)	LxWxH (")	Cat. No.
Cleaners Cabinet on leveller legs	1200x600x1800	48x24x72	JC1260
Cleaners Cabinet on casters	1200x600x1800	48x24x72	JC1260C
Cleaners Cabinet on leveler legs	800x500x1800	32x20x72	JC0850
Cleaners Cabinet on casters	800x500x1800	32x20x72	JC0850C

To ship assembled add — AS after catalog #

CABINETS WITH GLASS DOORS



New modern design cleanroom cabinets with safety glass doors allowing easy inspection of contents. Fabrication material stainless steel 304 electropolished finish.

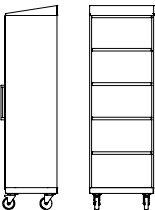

Product	LxWxH (mm)	LxWxH (")	Cat. No.
Full Length Cabinet 2 Glass Doors and 4 shelves on leveller legs	660x600x2100	26x24x83	JG0654
Full Length Cabinet 2 Glass Doors and 4 shelves on casters	660x600x2100	26x24x83	JG0654C
Full Length Cabinet 1 Glass Door and 4 shelves on leveller legs	500x600x2100	20x24x83	JG0554
Full Length Cabinet 1 Glass Door and 4 shelves on casters	500x600x2100	20x24x83	JG0554C

SOILED GARMENT CABINET - 1 DOOR



This cabinet is designed to assist in the degowning and collection of soiled garments for washing. The top flap allows for easy disposal and the door has a latch allowing easy emptying by cleaning contractor. Fabrication material stainless steel 304 electropolished finish.

Shipped flat packed

Product	LxWxH (mm)	LxWxH (")	Cat. No.
Soiled Garment Cabinet - Flat Top	660x540x1950	26x21x77	GC0608
Soiled Garment Cabinet - Sloping Top	660x540x2150	26x21x85	GC0608S

To ship assembled add – AS after catalog #